

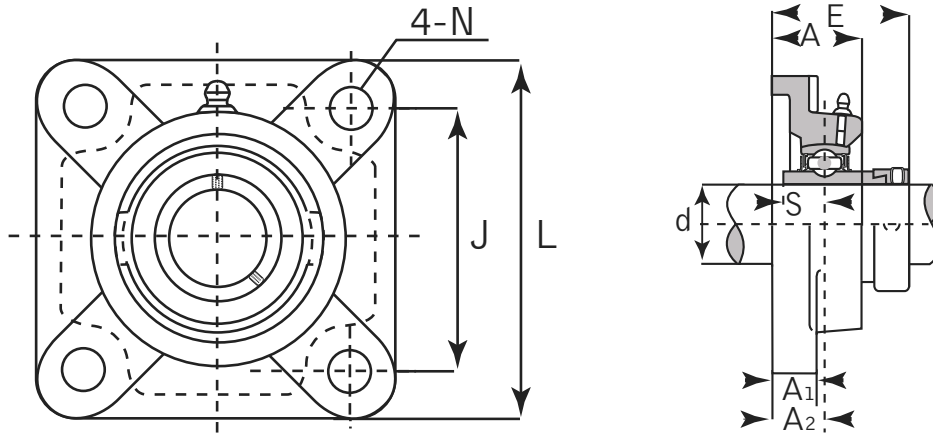

Four-Bolt Holes Flange Unit

Normal Duty



HCFU Eccentric Locking Collar

Unit No.	Shaft Dia. (inch / mm)	Dimensions (inch / mm)								Bolt Size	Bearing No.	Housing No.	Weight	
		d	L	J	A	A1	A2	N	E				S	kg
HCFU 201 201-8 202 202-10 203 203-11 204 204-12	12 mm 1/2 15 mm 5/8 17 mm 11/16 20 mm 3/4	3-3/8 76	2-1/2 54	1-5/32 25.5	19/32 11	3/4 15	15/32 11.5	1-51/64 45.6	0.6732 17.1	3/8 M10	HC 201 201-8 202 202-10 203 203-11 204 204-12	FU 204	0.89	1.96
HCFU 205 205-14 205-15 205-16	25 mm 7/8 15/16 1	3-21/32 93	2-3/4 70	1-3/16 30	19/32 15	3/4 19	15/32 12	1-13/16 45.9	0.6889 17.5	3/8 M10	HC 205 205-14 205-15 205-16	FU 205	0.81	1.78
HCFU 206 206-18 206-19 206-20	30 mm 1-1/8 1-3/16 1-1/4	4-11/64 106	3-1/4 82.5	1-9/32 32.5	5/8 16	25/32 20	15/32 12	1-31/32 50.1	0.7204 18.3	3/8 M10	HC 206 206-18 206-19 206-20	FU 206	1.16	2.55
HCFU 207 207-20 207-21 207-22 207-23	35 mm 1-1/4 1-5/16 1-3/8 1-7/16	4-9/16 116	3-5/8 92	1-3/8 35	43/64 17	53/64 21	35/64 14	2-3/32 53.3	0.7401 18.8	7/16 M12	HC 207 207-20 207-21 207-22 207-23	FU 207	1.50	3.30
HCFU 208 208-24 208-25	40 mm 1-1/2 1-9/16	5-5/64 129	4 101.5	1-17/32 39	43/64 17	15/16 24	35/64 14	2-5/16 58.9	0.8425 21.4	7/16 M12	HC 208 208-24 208-25	FU 208	1.95	4.29
HCFU 209 209-26 209-27 209-28	45 mm 1-5/8 1-11/16 1-3/4	5-5/16 135	4-9/64 105	1-37/64 40	45/64 18	15/16 24	5/8 16	2-5/16 58.9	0.8425 21.4	1/2 M14	HC 209 209-26 209-27 209-28	FU 209	2.27	4.99

Four-Bolt Holes Flange Unit

Normal Duty

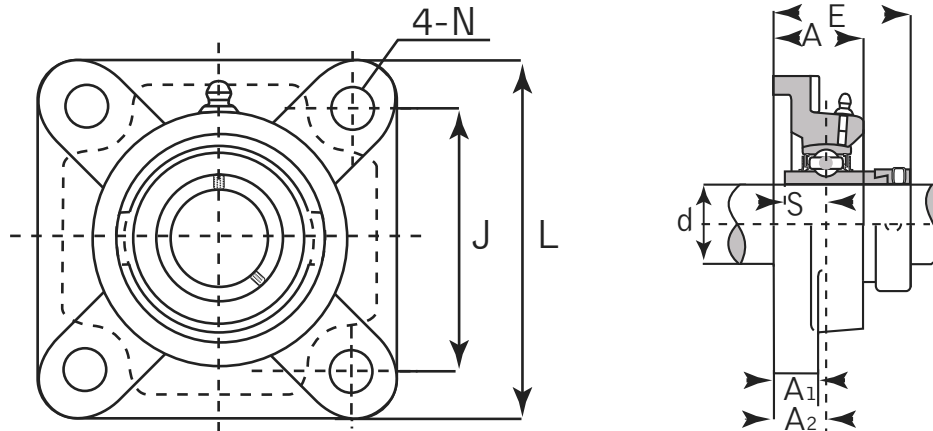

HCFU Eccentric Locking Collar

Unit No.	Shaft Dia. (inch / mm)	Dimensions (inch / mm)								Bolt Size	Bearing No.	Housing No.	Weight	
		d	L	J	A	A1	A2	N	E				S	kg
HCFU 210 210-30 210-31 210-32	50 mm 1-7/8 1-15/16 2	5-5/8 143	4-3/8 111	1-49/64 45	25/32 20	1-3/32 28	23/32 18	2-39/64 66.1	0.9685 24.6	5/8 M16	HC 210 210-30 210-31 210-32	FU 210	2.71	5.96
HCFU 211 211-32 211-34 211-35	55 mm 2 2-1/8 2-3/16	6-3/8 162	5-1/8 130	1-59/64 49	53-64 21	1-7/32 31	23/32 18	2-17/32 74.6	1.0905 27.7	5/8 M16	HC 211 211-32 211-34 211-35	FU 211	3.70	8.14
HCFU 212 212-36 212-38 212-39	60 mm 2-1/4 2-3/8 2-7/16	6-37/64 175	5-5/8 143	1-7/64 53.5	55/64 22	1-11/32 34	23/32 18	3-3/16 80.8	1.2204 31	5/8 M16	HC 212 212-36 212-38 212-39	FU 212	4.59	10.10
HCFU 213 213-40	65 mm 2-1/2	7-1/4 184	5-55/64 149	2-9/32 58	55/64 22	1-1/2 38	23/32 18	3-17/32 89.6	1.3425 34.1	5/8 M16	HC 213 213-40	FU 213	5.99	13.18
HCFU 214 214-43 214-44	70 mm 2-11/16 2-3/4	7-13/32 188	5-63/64 152	2-21/64 59	29/32 23	1-1/2 38	23/32 18	3-17/32 89.6	1.3425 34.1	5/8 M16	HC 214 214-43 214-44	FU 214	6.39	14.06
HCFU 215 215-47 215-48	75 mm 2-15/16 3	7-7/8 200	6-17/64 159	2-7/16 62	15/16 24	1-39/64 41	23/32 18	3-49/64 95.8	1.4685 37.3	5/8 M16	HC 215 215-47 215-48	FU 215	7.32	16.10