

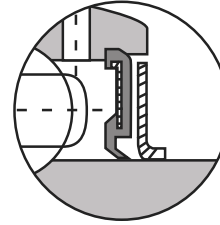

Ball Bearing Inserts

Stainless Steel - SSER Series

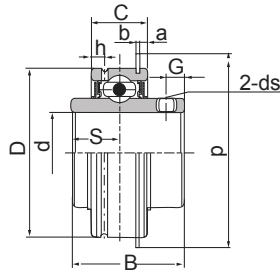

Dual Seal

Unit No.	Shaft Dia. (inch / mm)	Dimensions (inch / mm)										Basic Load Rating lbf / N		Mass		
		d	D	B	C	S	a	b	p	G	h	ds	Dynamic Cr	Static C0r	kg	lbs
SSER 201-8	1/2														0.26	0.57
202	15 mm														0.25	0.55
202-10	5/8	1.8504	1.219	0.626	0.406	0.094	0.042	2.067	0.177	0.150	1/4-28	2524	1320	0.24	0.53	
203	17 mm	47	31.0	15.9	10.3	2.3	1.1	52.5	4.5	3.8	M6 X 1	11228	5873	0.23	0.51	
204-12	3/4													0.22	0.49	
204	20 mm													0.21	0.46	
SSER 205-14	7/8													0.31	0.68	
205-15	15/16	2.0472	1.375	0.750	0.515	0.094	0.042	2.272	0.197	0.203	1/4-28	2524	1320	0.30	0.66	
205	25 mm	52	34.9	19	13.1	2.3	1.1	57.7	5	5.1	M6 X 1	11228	5873	0.29	0.64	
205-16	1													0.28	0.62	
SSER 206-18	1-1/8													0.40	0.88	
206	30 mm	2.4409	1.500	0.875	0.625	0.125	0.065	2.658	0.197	0.219	1/4-28	3504	1909	0.39	0.86	
206-19	1-3/16	62	38.1	22.2	15.8	3.2	1.6	67.5	5	5.6	M6 X 1	15588	8490	0.38	0.84	
206-20	1-1/4													0.36	0.79	
SSER 207-20	1-1/4													0.62	1.37	
207-21	1-5/16	2.8346	1.688	0.937	0.688	0.125	0.065	3.078	0.236	0.219	5/16-24	4624	2595	0.59	1.30	
207-22	1-3/8	72	42.8	23.8	17.5	3.2	1.6	78.2	6	5.6	M8 X 1	20568	11528	0.56	1.23	
207	35 mm													0.55	1.21	
207-23	1-7/16													0.53	1.17	
SSER 208-24	1-1/2													0.91	2.01	
208-25	1-9/16	3.1496	1.937	1.093	0.750	0.125	0.065	3.406	0.315	0.250	5/16-24	4632	3034	0.88	1.94	
208	40 mm	80	49.2	27.8	19	3.2	1.6	86.5	8	6.4	M8 X 1	20604	13493	0.86	1.89	